



10 High Storrs Crescent, High Storrs, Sheffield, S11 7JY



# 10 High Storrs Crescent

## High Storrs

Guide Price

# £500,000

Guide Price £500,000 to £525,000

Located in the heart of High Storrs, this stunning, extended four-bedroom semi-detached home offers bright, spacious and modern living in one of the area's most sought-after neighbourhoods. Stylishly presented throughout, it combines a trendy interior with generous accommodation, all within easy reach of excellent amenities, highly regarded schools, transport links and beautiful green spaces.

The hub of the home is the impressive open-plan kitchen and living area, featuring a central island/breakfast bar and contemporary finishes—perfect for family life and entertaining. A separate, modern lounge provides additional flexible living space, and the property is arranged over three floors, offering four well-proportioned bedrooms and well-designed bathrooms.

Outside, the house benefits from a driveway and a superb rear garden with established flower borders, a lawn and an attractive Indian flagstone patio, creating a wonderful setting for outdoor dining and relaxation.

With Endcliffe Park, Bingham Park and the breathtaking Peak District all close by, the location offers an abundance of opportunities for walking, cycling and enjoying the outdoors.

Bright, spacious and beautifully extended, this exceptional home presents a rare opportunity to secure a standout property in a highly desirable part of the city.



- Stunning extended four bedroom semi-detached spanning over three floors
- Bright spacious and modern with an open plan kitchen diner opening onto the patio
- Incredible views to the front overlooking Sheffield
- Driveway to the front and a beautiful garden to the rear with patio seating area, lawn and flower beds
- Highly desirable local schools nearby
- Perfect for a family with a bathroom and a second shower room
- Early viewings are highly recommended to avoid missing out on such a brilliant family home
- Close to Endcliffe Park and Bingham Park
- Call Saxton Mee Banner Cross to arrange your viewing





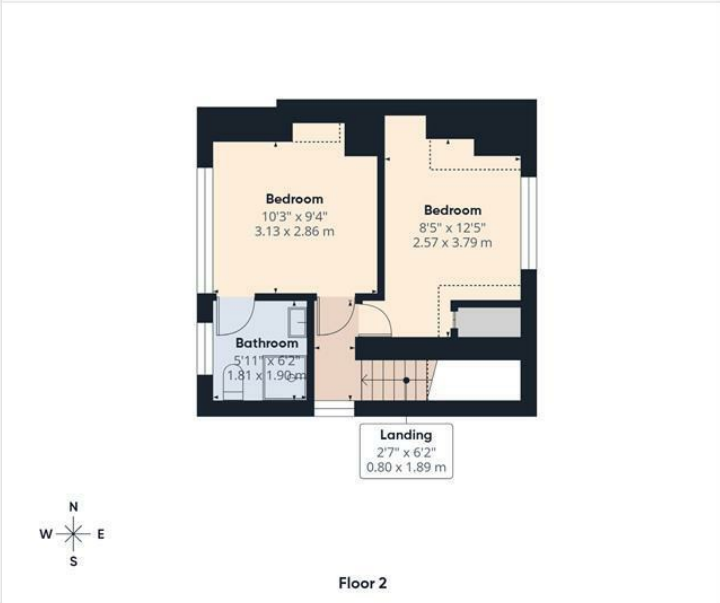

**Approximate total area<sup>(1)</sup>**  
1187 ft<sup>2</sup>  
110.3 m<sup>2</sup>

**Reduced headroom**  
19 ft<sup>2</sup>  
1.8 m<sup>2</sup>

(1) Excluding balconies and terraces

Reduced headroom  
..... Below 5 ft/1.5 m

Calculations reference the RICS IPMS 3C standard. Measurements are approximate and not to scale. This floor plan is intended for illustration only.

**GIRAFFE360**

While we endeavour to make our sales particulars fair, accurate and reliable, they are only a general guide to the property and, accordingly, if there is any point, which is of particular importance to you, please contact the relevant office. The Agents have not tested any apparatus, equipment, fittings or services and so cannot verify they are in working order. The buyer is advised to obtain verification. Please note all the measurement details are approximate and should not be relied upon as exact. All plans, floor plans and maps are for guidance purposes only and are not to scale. Under no circumstances should they be relied upon as exact or for use in planning carpets and other such fixtures, fittings or furnishings. YOUR HOME IS AT RISK IF YOU DO NOT KEEP UP REPAYMENTS ON A MORTGAGE OR OTHER LOAN SECURED ON IT. 'A Life Assurance policy may be requested.' 'Written Quotations of credit terms available on request.'

Banner Cross  
T: 0114 268 3241  
E: [bannercross@saxtonmee.co.uk](mailto:bannercross@saxtonmee.co.uk)  
[www.saxtonmee.co.uk](http://www.saxtonmee.co.uk)

Hathersage  
T: 01433 650009  
E: [hathersage@saxtonmee.co.uk](mailto:hathersage@saxtonmee.co.uk)

Bakewell  
T: 01629 815307  
E: [bakewell@saxtonmee.co.uk](mailto:bakewell@saxtonmee.co.uk)

Matlock  
T: 01629 828250  
E: [matlock@saxtonmee.co.uk](mailto:matlock@saxtonmee.co.uk)

